

CART WEIGHT: 130 LBS

CART DIMENSIONS: 57" X 36" X 26.5"

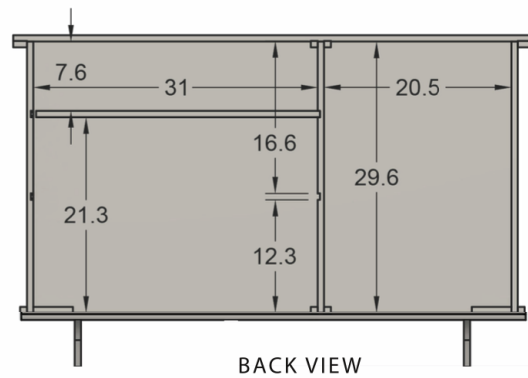

PANEL MATERIAL

PANEL CORE: 3/4" POPLAR PLYWOOD

EXTERIOR: FORMICA LAMINATE

INTERIOR LINING: WATERPROOF PHENOLIC LINING



COUNTERTOP MATERIAL

PANEL CORE: 3/4" POPLAR PLYWOOD

TOP FACE: FORMICA LAMINATE

EDGE BANDING: SOLID WOOD WITH WATER-BASED POLYURETHANE TOP COAT

UNDERSIDE: WATERPROOF PHENOLIC LINING



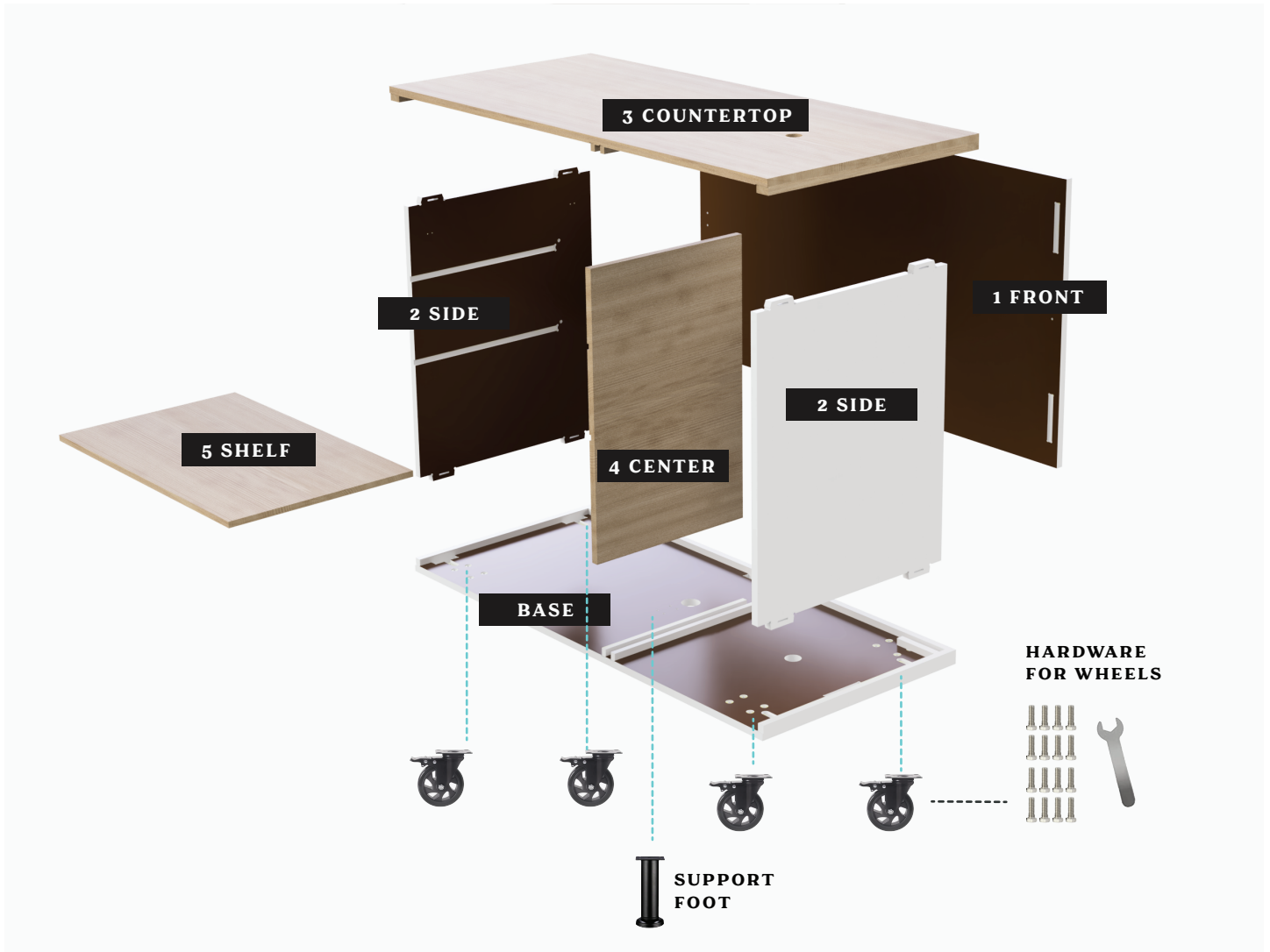

MOBILE CART ASSEMBLY

- 1- Right out of the box, attach the wheels to the base using the hardware provided.

Flip the base upside down and align the holes on the wheel plate to the holes on the underside of the base. Screw in the bolts by hand then tighten with the wrench.

*The wheels stay bolted to the base, do not remove when you disassemble the cart

Flip over the base so the wheels are on the ground. Lock at least 2 of the wheels to steady the base before you start to assemble the cart.

- 2- All panels are labeled and number. Place the panels on the base in numerical order.

- 3- Each side panel has 4 locking points. Slide the metal plates (located on the base and countertop) into the 4 slots on each side panel.

SUPPORT FOOT

The foot adds additional support and is only necessary if your setup has heavy equipment.

If you choose to use the foot, place it underneath the cart after you fully assemble and park your cart. Ideal placement is underneath the center/middle of your base.



Twist the foot clockwise to increase the height. Twist until tight and snug underneath the cart.



CLEANING INSTRUCTIONS FOR FORMICA LAMINATE

EVERY DAY CLEANING

- 1- Use a damp, non-abrasive cotton cloth and a mild liquid detergent or household cleaner.
- 2- Rinse with water using a clean non-abrasive cotton cloth. Take care not to flood the laminate, especially near seams.
- 3- Dry the surface with a non-abrasive cotton cloth.

WHAT TO AVOID

- Abrasive pads:
 - Scouring powders
 - Steel wool
 - Scotch-Brite™
 - Sandpaper
- Abrasive cleaners:
 - Scouring powders
 - Ajax® OR Comet®
 - Magic Eraser
- Acidic or Alkali based Cleansers

RECOMMENDED CLEANERS

- Liquid dish soap like Dawn®
- Fantastik® All Purpose Cleaner
- Formula 409®
- Pine-Sol® (original formula)
- Windex®

TOUGHER STAINS: THE BAKING SODA METHOD

- Apply paste of baking soda and water.
- Wipe up the paste with damp non-abrasive cotton cloth.
- Rinse clean with water.